

Proposal for Värmdö Municipality
Tomás Saraceno
2014

LOCATION

Värmdö Municipality, Sweden

Location on site,



Location on site
Top view

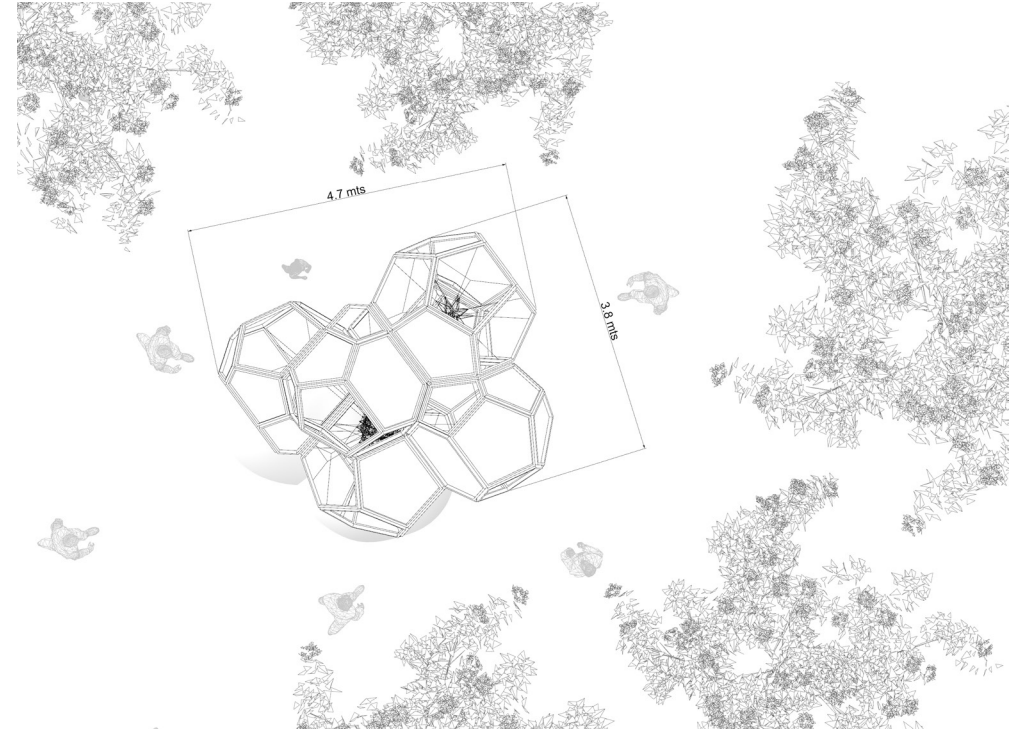

Pictures of the site

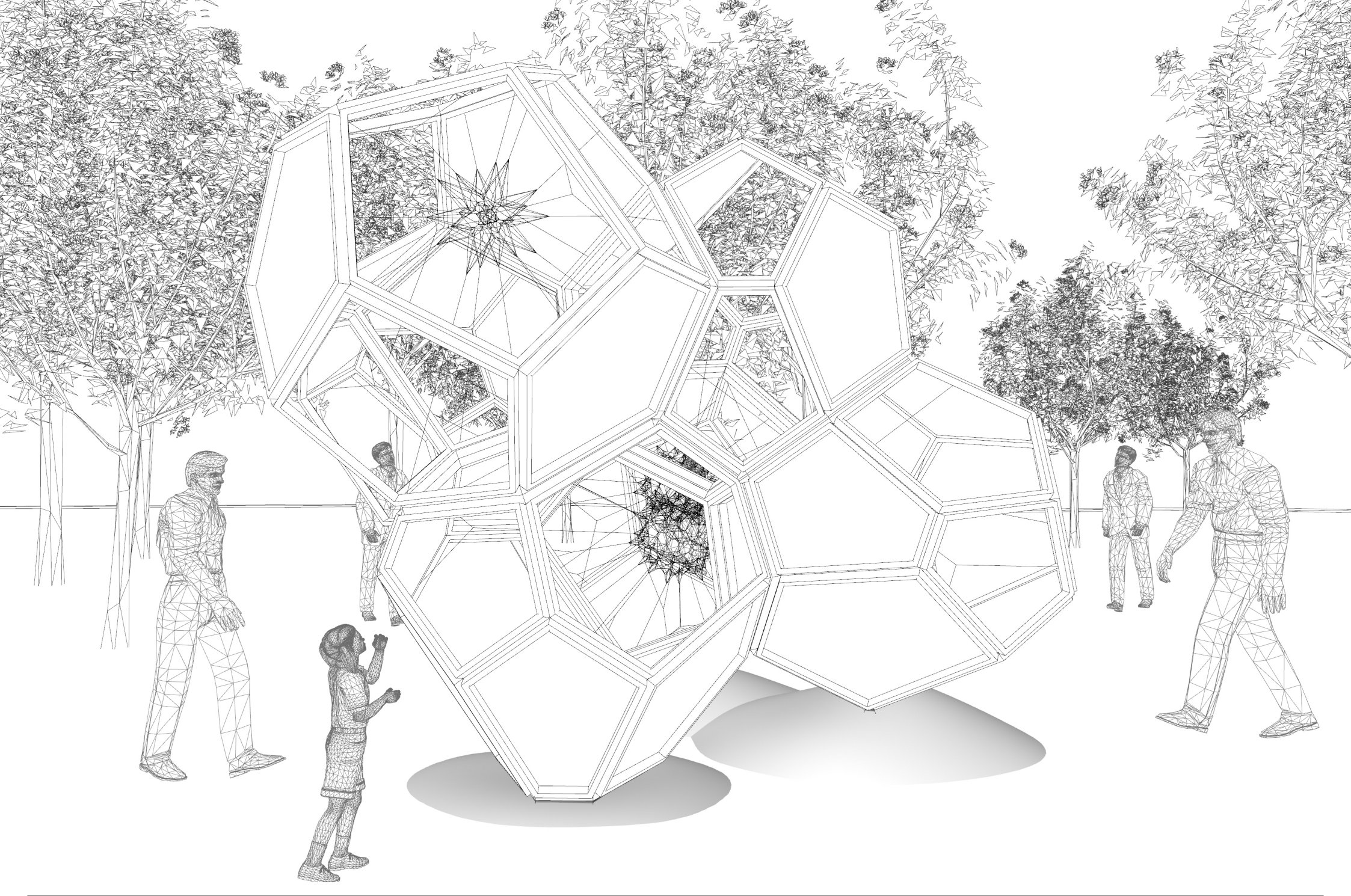

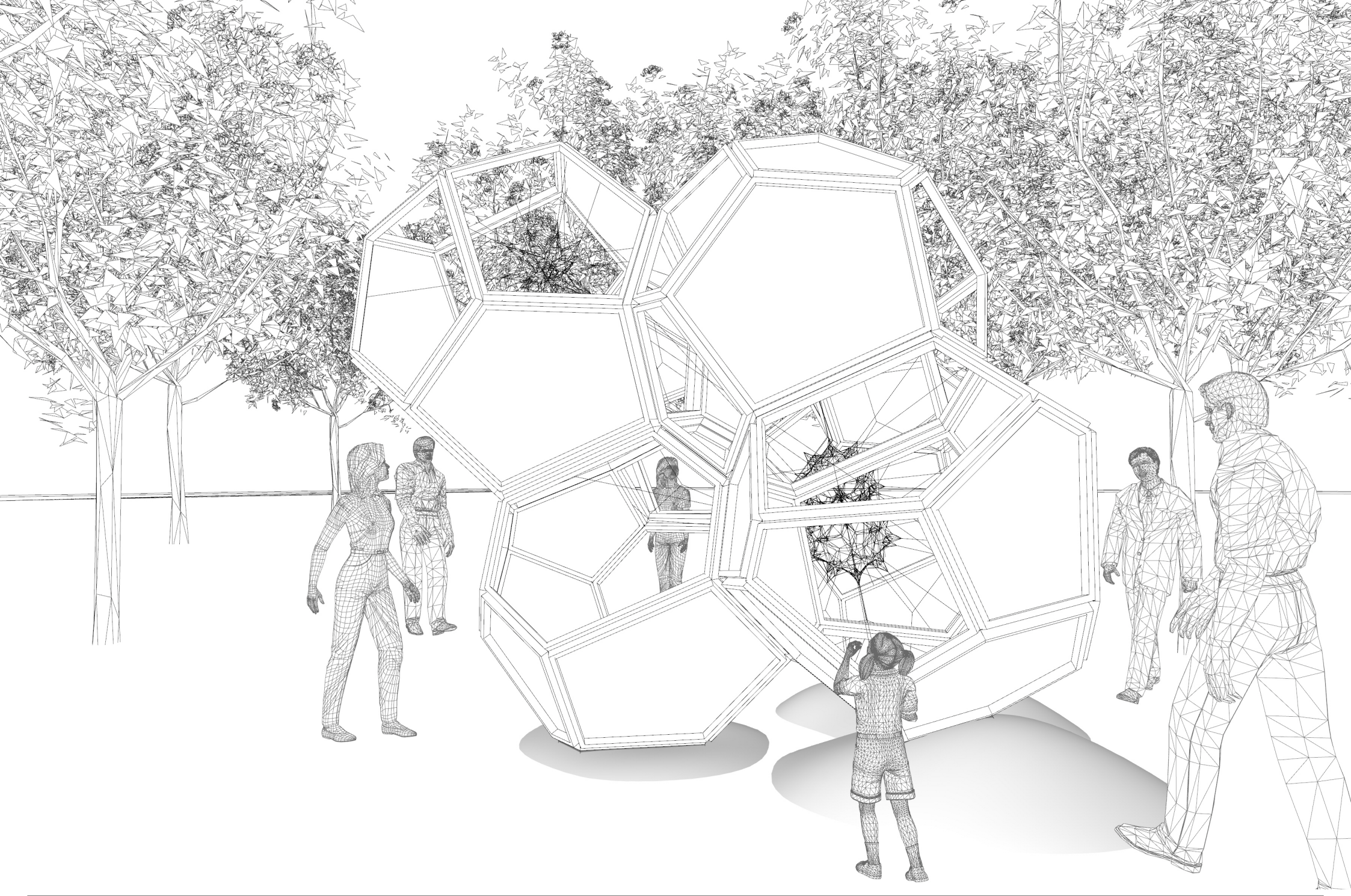

DIMENSIONS

4.7 x 3.8 x 3.8 mts

materials: stainless steel structure, and stainless steel cable of different thicknes

Top view

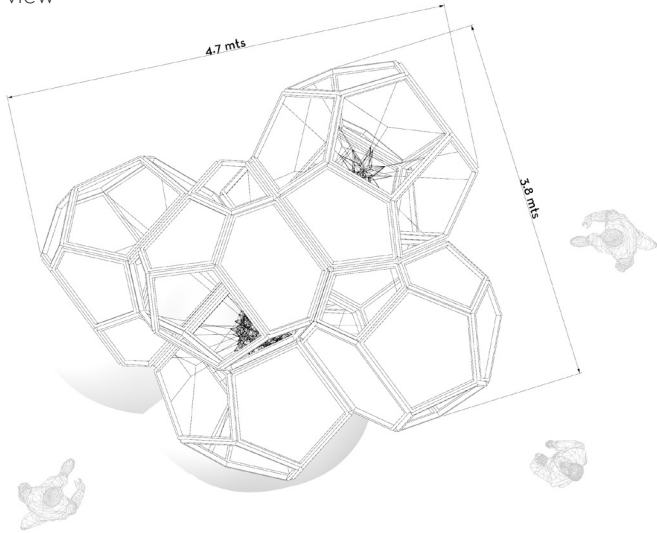

Perspective view

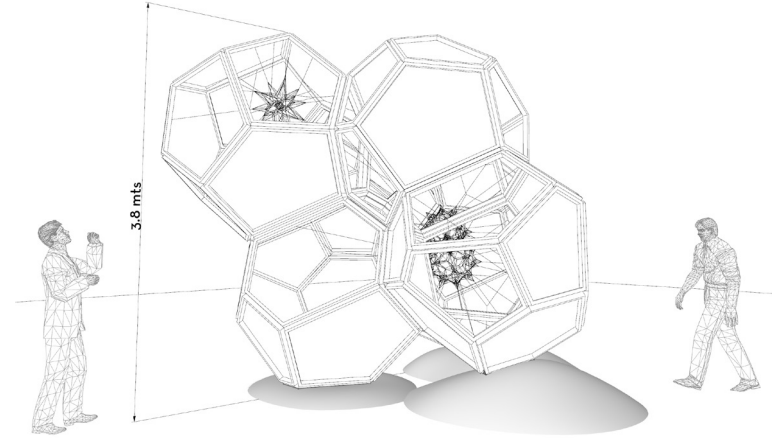

Front view

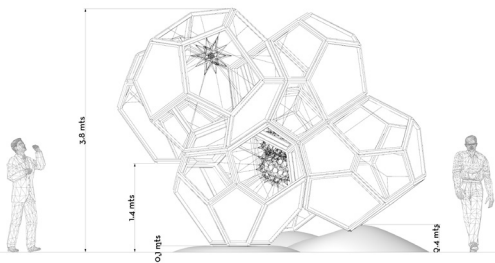

Right view

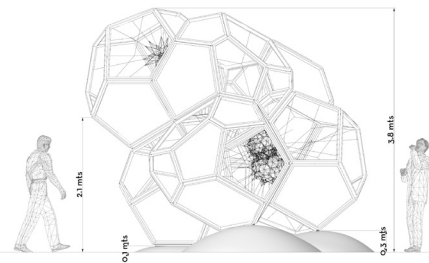

Left view

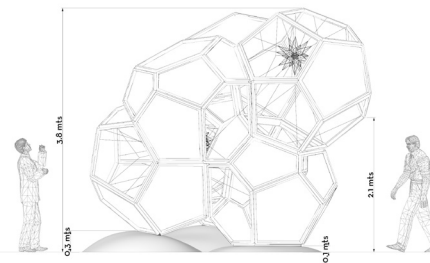

Back view

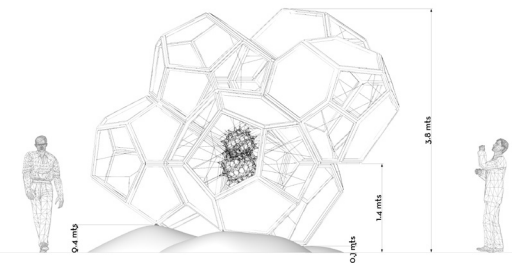

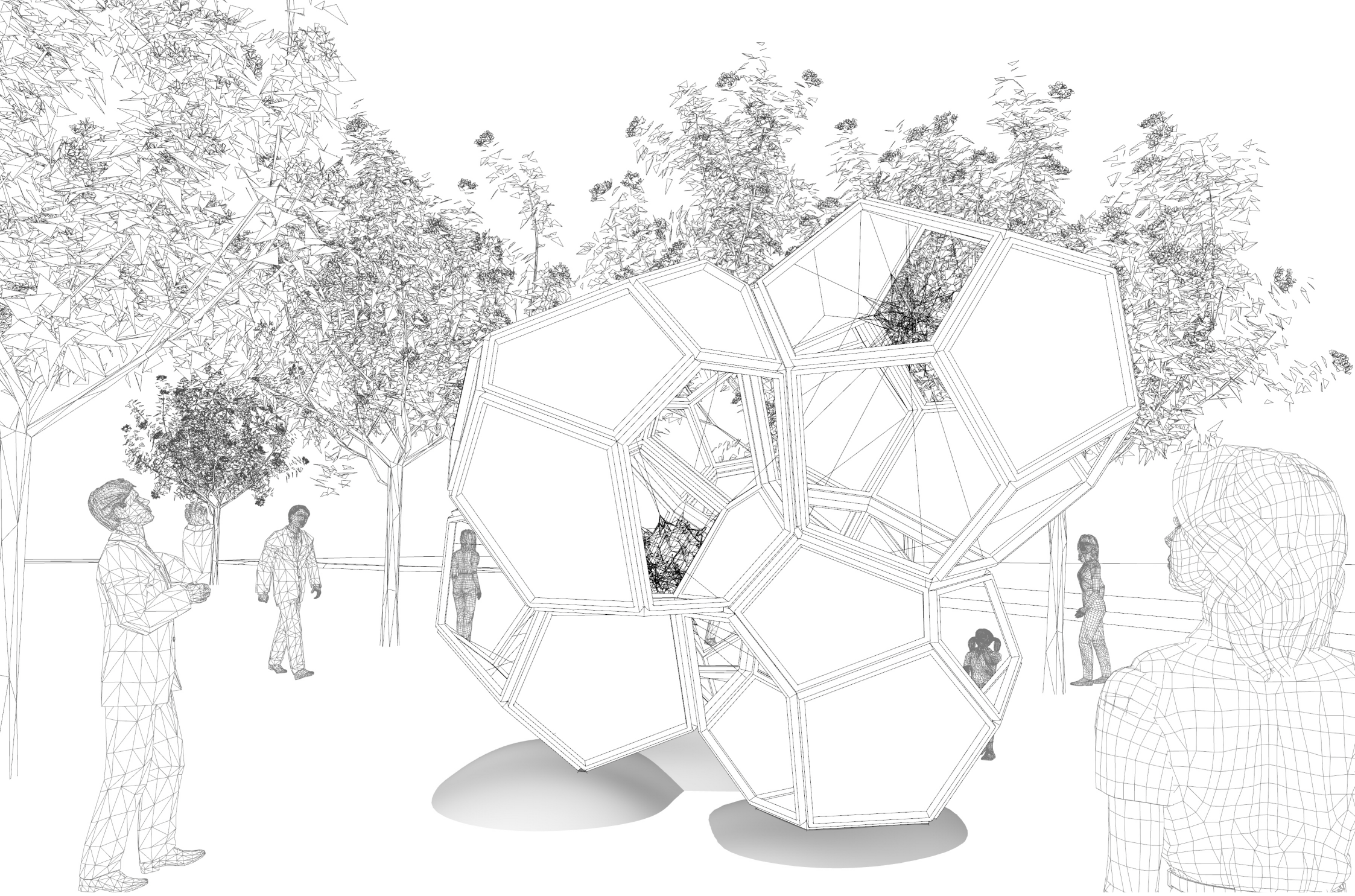

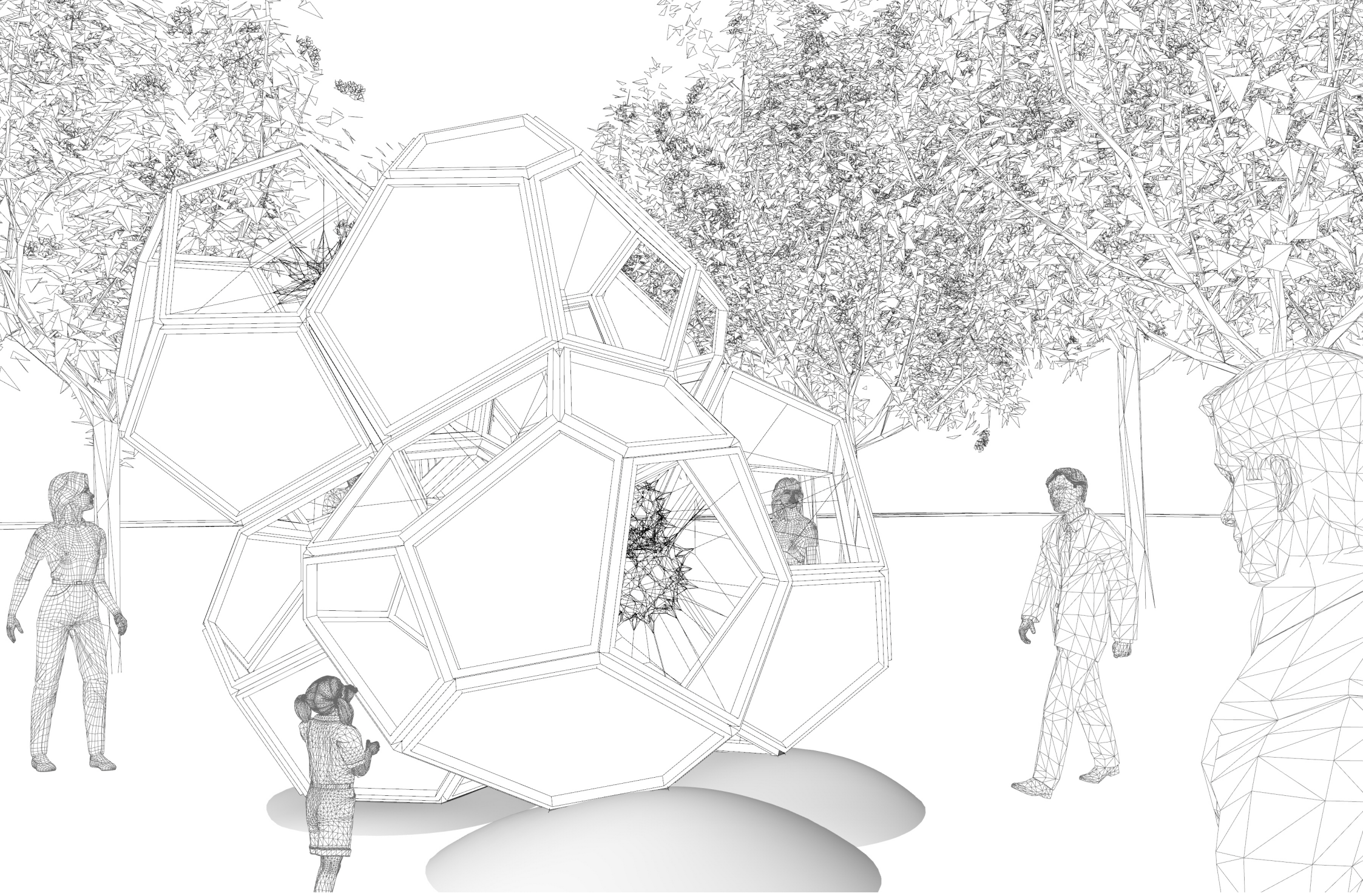

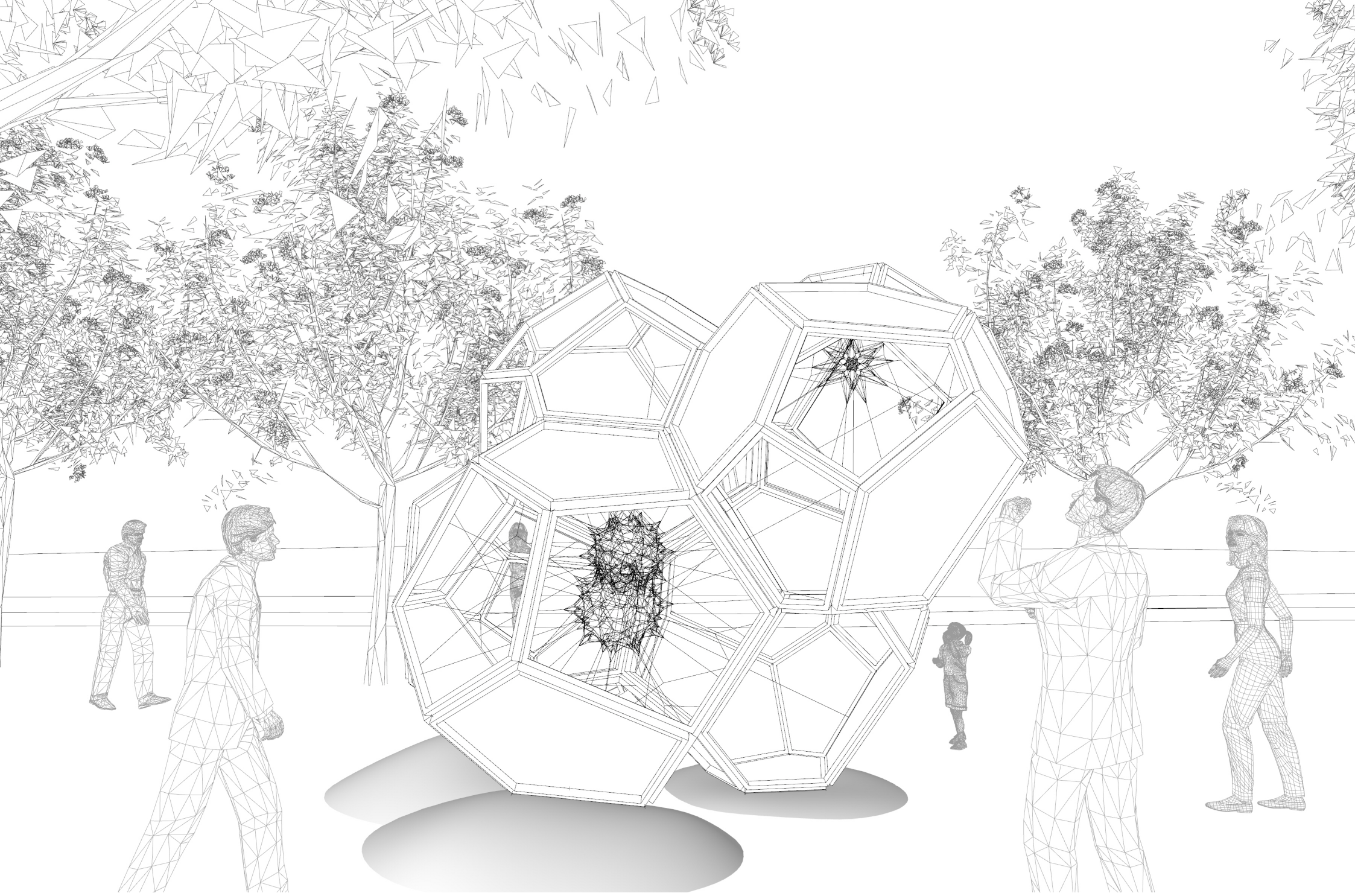

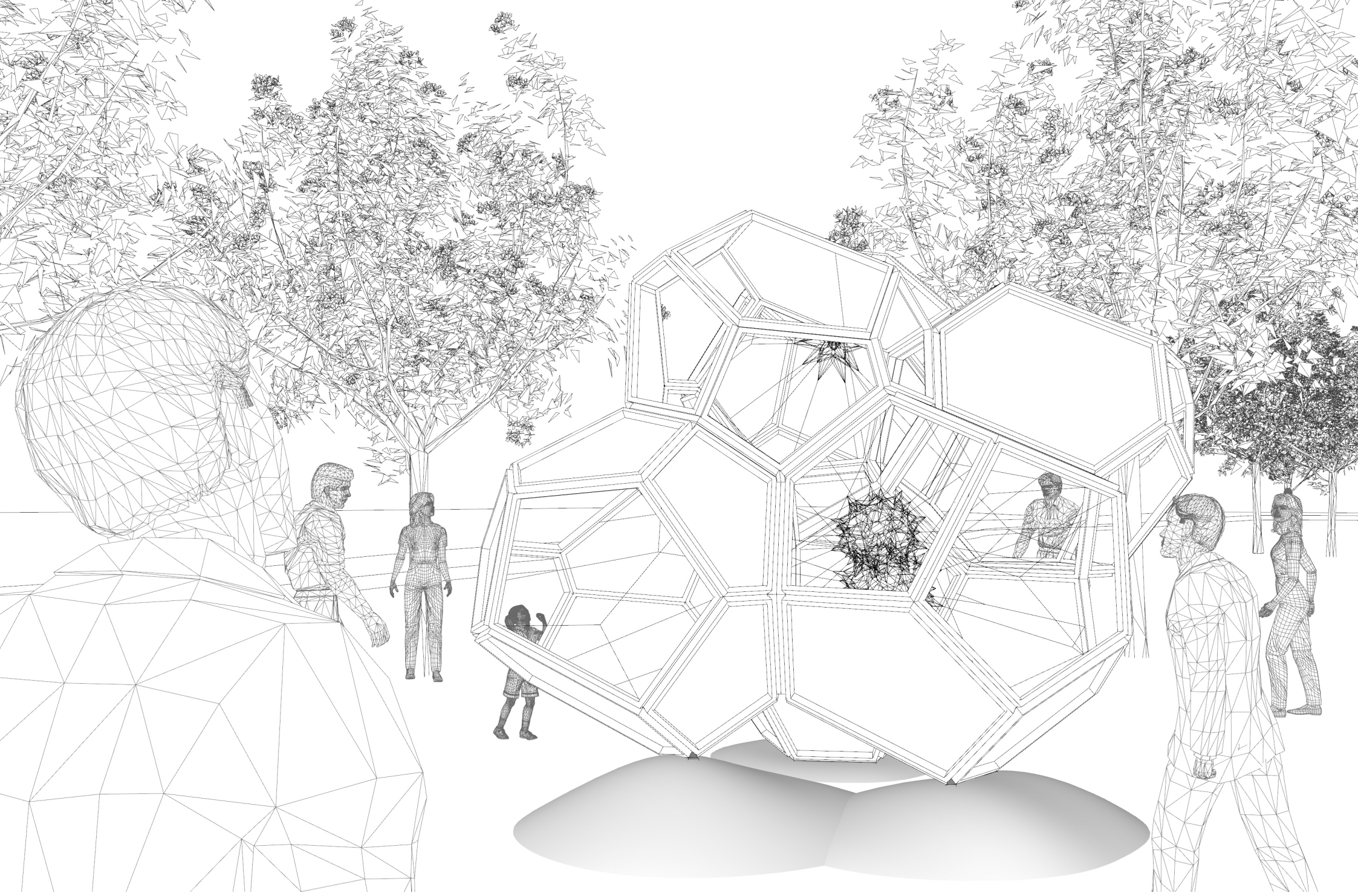

GROUND STRUCTURE

Concept Idea

Thee support structures will fix the artwork to the ground.
These elements will be covered by small hills of grass.

1. Placing the concrete fondation and support structure on the ground.

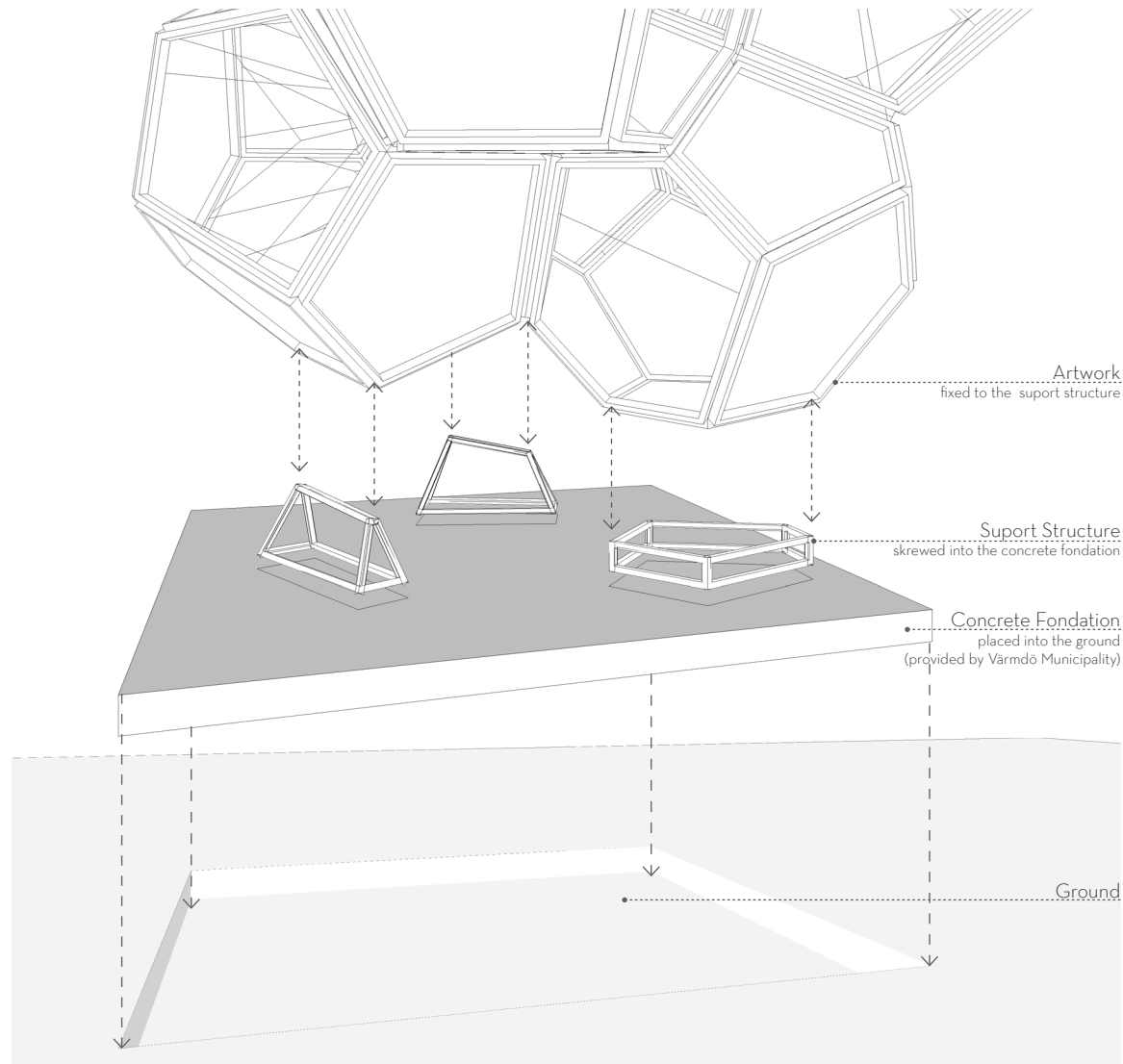

2. Artwork fixed to the support structure is covered with grass

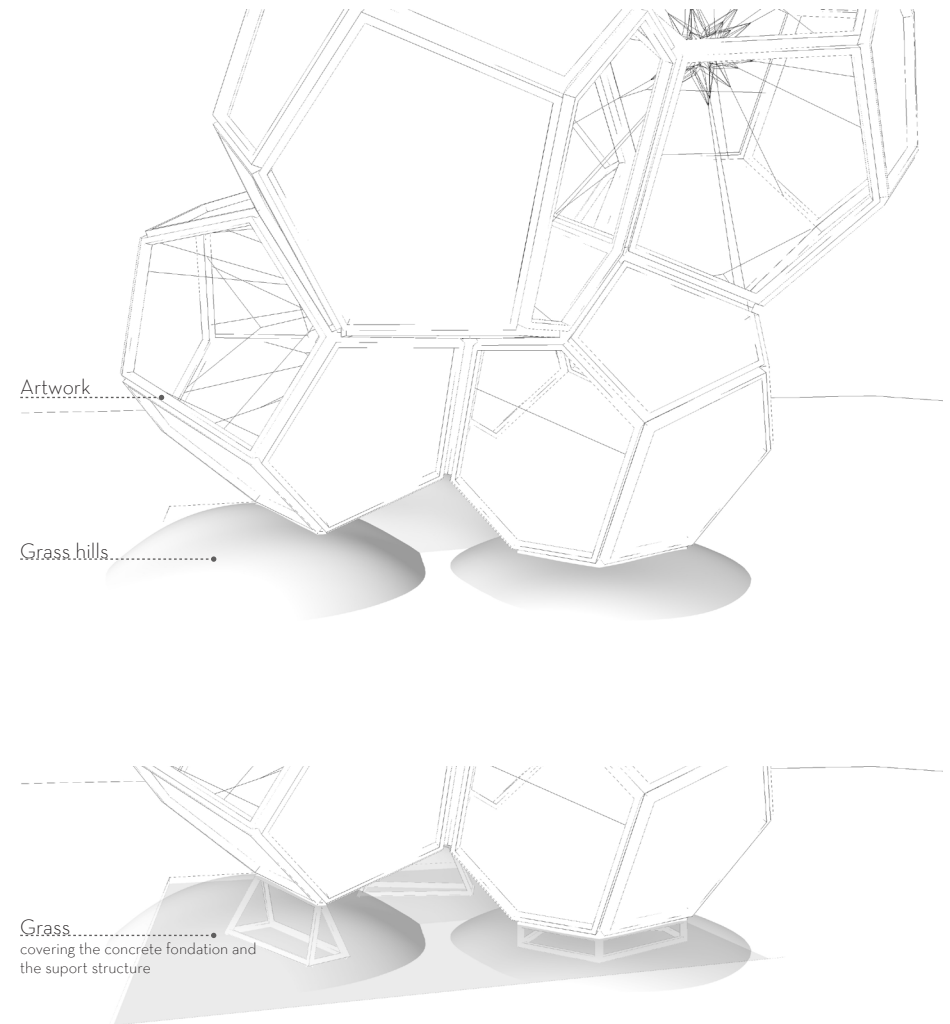

SAFETY CABLES TO FIX STRUCTURE TO GROUND

Concept Idea

During a windy day, it will be possible to temporary add some cables to the installation in order to reinforce the attachment of the artwork to the ground

Top view

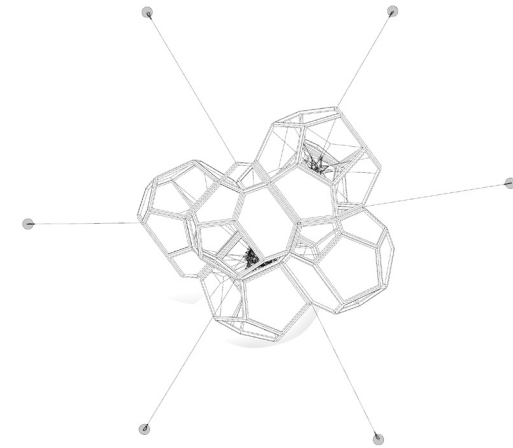

Perspective view

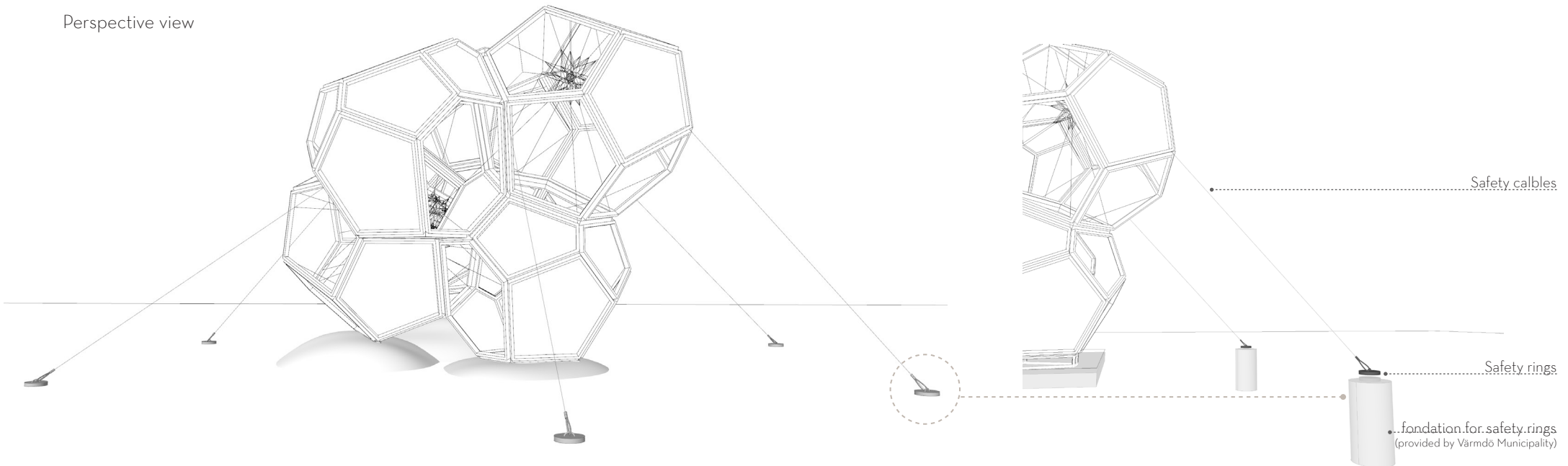



Detail of Interior Net
Material: stainless steel cable of different thickness



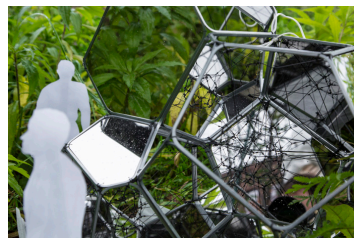

Reference project

CLOUD CITY AT THE METROPOLITAN MUSEUM OF ART

The Metropolitan Museum of Art, New York, 2012

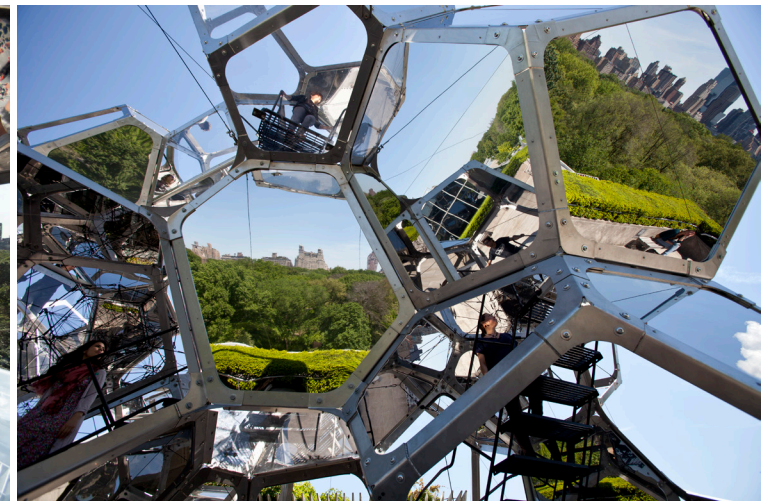
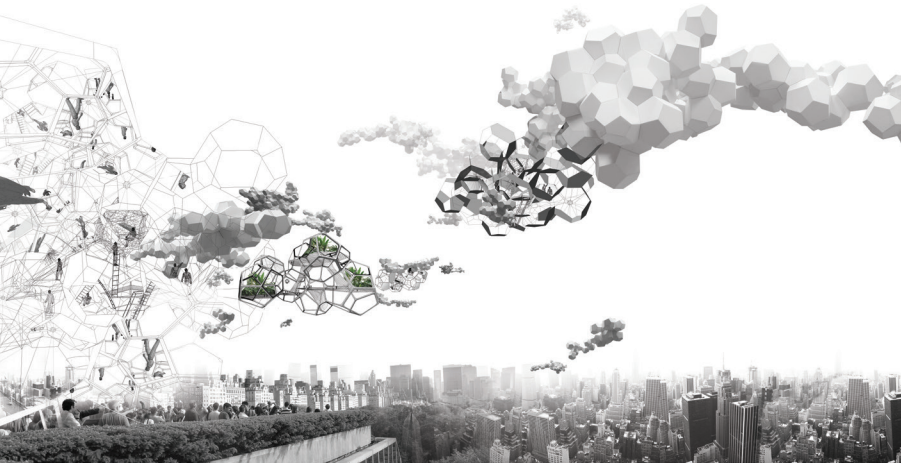

The information contained within this bounded document is the property of studio tomas saraceno gmbh. Copyright is reserved by them and the drawings are issued on the condition that they are not copied, reproduced, retained or disclosed to any unauthorised person without prior consent in writing of studio tomas saraceno gmbh. The information contained within this bound document is for information purpose only.

Studio Tomás Saraceno
Hauptstrasse 11/12
10317 Berlin
T + 49 30 39881180 /-81 /-82
Skype: studiosaraceno
<http://tomassaraceno.com/>